

ART. 9626

Tappo femmina, aisi 316 / A4

Hex cup, aisi 316 / A4

Esecuzione: Microfusione

Execution: Microcasting

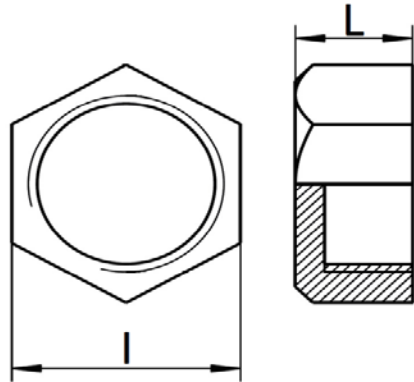

Filettatura: conforme a EN 10226-1 (EX ISO 7-1)
(filetto maschio conico, filetto femmina cilindrico)

Conicità 1:16 sul diametro

Angolo del filetto 55°

Pressione massima d'esercizio 150 Lbs (Libbre) = 10,34 BAR PN10

Thread: according to EN 10226-1 (EX ISO 7-1)

(conical male thread, cylindric female thread)

Taper 1:16 on diameter

Angle of threads 55°

Maximum operating pressure 150 lbs = 10,34 Bar PN 10

Codice Articolo
Item Number

M
size

DN/ID

I
(mm)

L
(mm)



Box



Master carton

| Codice Articolo Item Number | M size | DN/ID | I (mm) | L (mm) | Box | Master carton |
|--------------------------------|-----------|-------|-----------|-----------|-----|---------------|
| 9626-4-1/8 | 1/8" | 8 | 12,5 | 11,8 | 5 | / |
| 9626-4-1/4 | 1/4" | 10 | 16 | 15 | 5 | 200 |
| 9626-4-3/8 | 3/8" | 15 | 19,5 | 15,4 | 5 | / |
| 9626-4-1/2 | 1/2" | 20 | 24 | 17,1 | 5 | 250 |
| 9626-4-3/4 | 3/4" | 25 | 29,5 | 18,5 | 5 | / |
| 9626-4-1 | 1" | 32 | 36,5 | 21 | 5 | 150 |
| 9626-4-1-1/4 | 1"1/4 | 40 | 45,5 | 23,7 | 5 | / |
| 9626-4-1-1/2 | 1"1/2 | 50 | 52 | 23,7 | 5 | / |
| 9626-4-2 | 2" | 50 | 64 | 27,5 | 2 | 40 |